



“Pristina City Center” is a business center that strives to have not only the most modern architecture, but also dedicated projects with staff and consolidated partners. Our collaborations are an added value in achieving common goals while joining the public and private sector in a single communication network.

 **IN JUST  
FEW MINUTES**

FADIL VOKRRI  
Stadium



GRAND  
Hotel



5 min

5 min



Municipality  
Building of  
Pristina

10 min

7 min



University  
of Pristina

3 min

5 min



BILL CLINTON  
Statue

5 min



KEDS



Cathedral of  
Saint Mother Teresa

# SURFACE ANALYSIS EAST TOWER

# 2

FLOOR 31  
PENTHOUSE

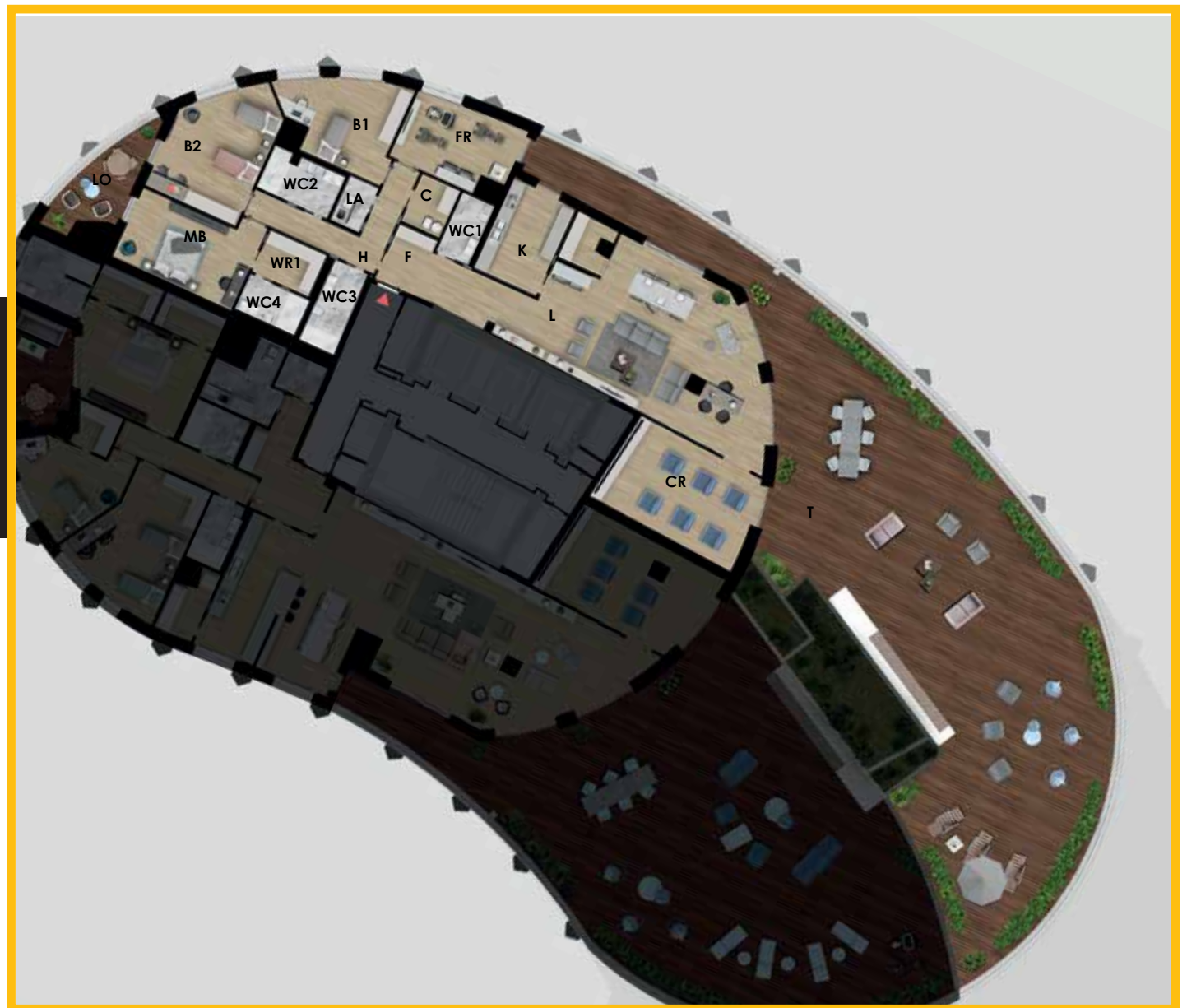
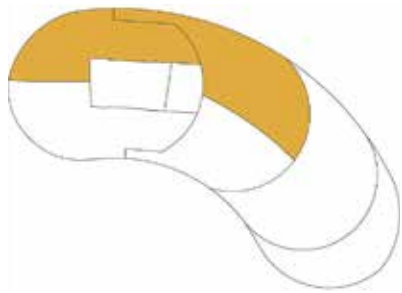

**GROSS SURFACE** 563,00 m<sup>2</sup>  
(selling surface)

**GROSS SURFACE APT.** 294,30 m<sup>2</sup>

**GROSS SURFACE TERRACE** 268,70 m<sup>2</sup>

**TOTAL (NET SURFACE)** 490,30 m<sup>2</sup>

Subdivision of the spaces (net surface)

L	Living	69,10 m <sup>2</sup>
K	Kitchen	12,60 m <sup>2</sup>
MB	Master Bedroom	19,30 m <sup>2</sup>
WR	Wardrobe Room	5,30 m <sup>2</sup>
B1	Bedroom 1	17,60 m <sup>2</sup>
B2	Bedroom 2	22,50 m <sup>2</sup>
FR	Flex Room	15,70 m <sup>2</sup>
CR	Cinema Room	27,30 m <sup>2</sup>
WC1	Bathroom 1	4,20 m <sup>2</sup>
WC2	Bathroom 2	6,40 m <sup>2</sup>
WC3	Bathroom 3	6,00 m <sup>2</sup>
WC4	Bathroom 4	4,60 m <sup>2</sup>
LA	Laundry	2,80 m <sup>2</sup>
C	Closet	4,00 m <sup>2</sup>
F	Foyer	8,40 m <sup>2</sup>
H	Hallway	12,30 m <sup>2</sup>
LO	Loggia	11,10 m <sup>2</sup>
T	Terrace	241,10 m <sup>2</sup>

