



“Pristina City Center” is a business center that strives to have not only the most modern architecture, but also dedicated projects with staff and consolidated partners. Our collaborations are an added value in achieving common goals while joining the public and private sector in a single communication network.

 **IN JUST  
FEW MINUTES**

FADIL VOKRRI  
Stadium



GRAND  
Hotel



5 min

5 min



Municipality  
Building of  
Pristina

10 min

7 min



University  
of Pristina

3 min

5 min



BILL CLINTON  
Statue

5 min



KEDS



Cathedral of  
Saint Mother Teresa

# SURFACE ANALYSIS EAST TOWER

# 4

FLOOR 30  
PENTHOUSE

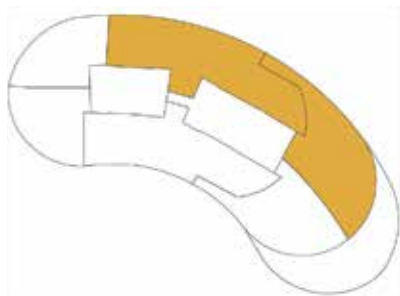

GROSS SURFACE <small>(selling surface)</small>	560,90 m <sup>2</sup>
GROSS SURFACE APT.	339,50 m <sup>2</sup>
GROSS SURFACE TERRACE	221,40 m <sup>2</sup>

TOTAL (NET SURFACE) 483,30 m<sup>2</sup>

Subdivision of the spaces (net surface)

L/K	Living/Kitchen	136,10 m <sup>2</sup>
MB	Master Bedroom	21,10 m <sup>2</sup>
WR1	Wardrobe Room 1	3,80 m <sup>2</sup>
WR2	Wardrobe Room 2	4,20 m <sup>2</sup>
B1	Bedroom 1	18,90 m <sup>2</sup>
B2	Bedroom 2	22,70 m <sup>2</sup>
FR	Flex Room	17,40 m <sup>2</sup>
WC1	Bathroom 1	4,30 m <sup>2</sup>
WC2	Bathroom 2	5,60 m <sup>2</sup>
WC3	Bathroom 3	5,90 m <sup>2</sup>
WC4	Bathroom 4	6,10 m <sup>2</sup>
C	Closet	4,30 m <sup>2</sup>
LA	Laundry	4,70 m <sup>2</sup>
F	Foyer	9,10 m <sup>2</sup>
H	Hallway	13,60 m <sup>2</sup>
LO	Loggia	16,90 m <sup>2</sup>
T	Terrace	188,60 m <sup>2</sup>

