



“Pristina City Center” is a business center that strives to have not only the most modern architecture, but also dedicated projects with staff and consolidated partners. Our collaborations are an added value in achieving common goals while joining the public and private sector in a single communication network.

 **IN JUST
FEW MINUTES**

FADIL VOKRRI
Stadium



GRAND
Hotel



5 min

5 min



Municipality
Building of
Pristina

10 min

7 min



University
of Pristina

3 min

5 min



BILL CLINTON
Statue

5 min



KEDS



Cathedral of
Saint Mother Teresa

SURFACE ANALYSIS EAST TOWER



FLOOR 30
PENTHOUSE

1

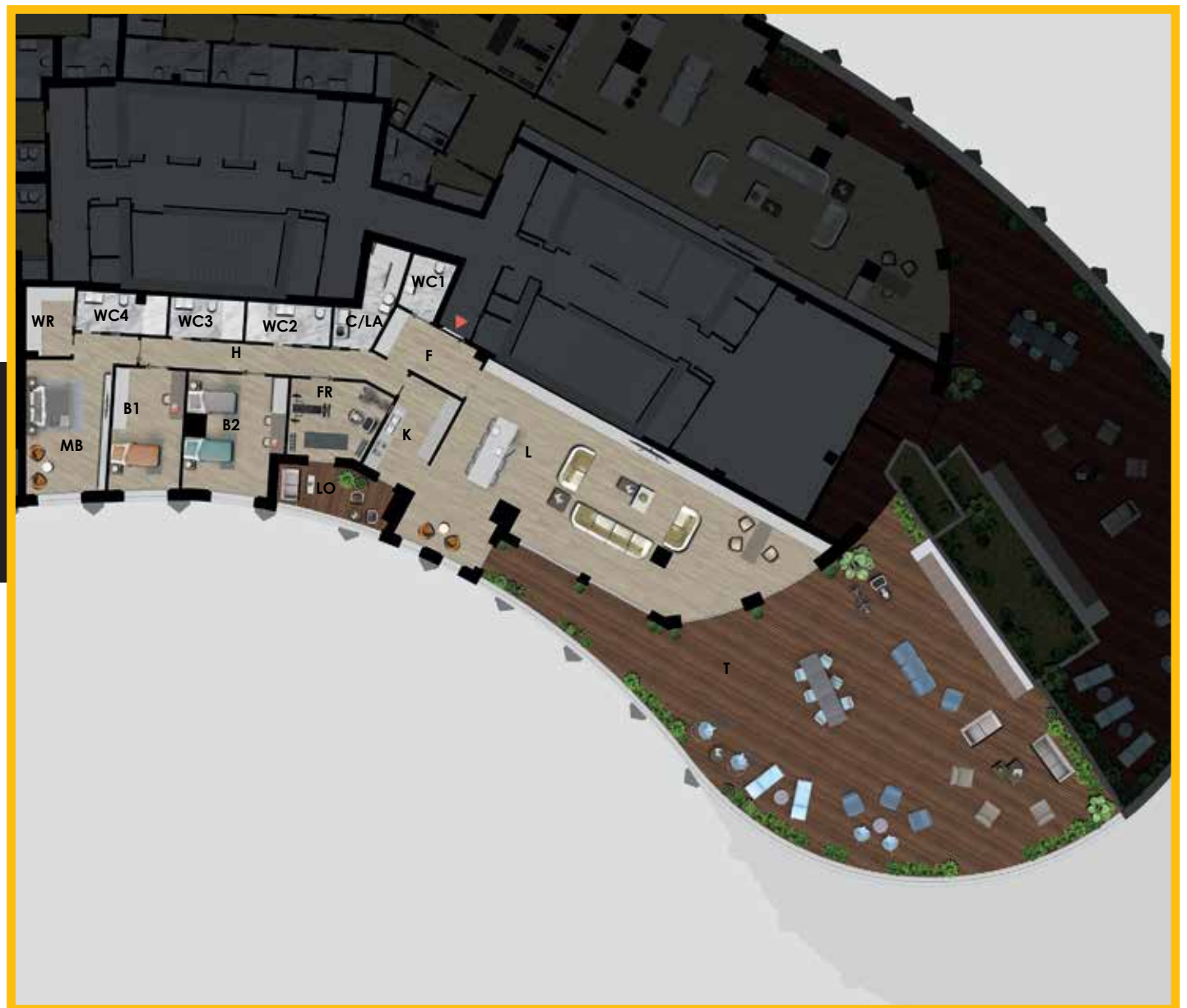
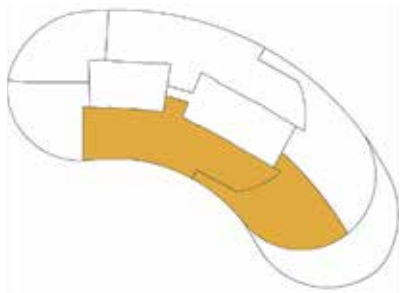

GROSS SURFACE (selling surface) **509,50 m²**
GROSS SURFACE APT. **286,80 m²**
GROSS SURFACE TERRACE **222,70 m²**

TOTAL (NET SURFACE) **454,00 m²**

Subdivision of the spaces (net surface)

L	Living	98,90 m ²
K	Kitchen	10,90 m ²
MB	Master Bedroom	23,10 m ²
WR	Wardrobe Room	5,70 m ²
B1	Bedroom 1	15,40 m ²
B2	Bedroom 2	19,40 m ²
FR	Flex Room	12,60 m ²
WC1	Bathroom 1	4,30 m ²
WC2	Bathroom 2	6,10 m ²
WC3	Bathroom 3	5,30 m ²
WC4	Bathroom 4	6,50 m ²
LA/C	Laundry/Closet	7,40 m ²
F	Foyer	9,10 m ²
H	Hallway	14,00 m ²
LO	Loggia	9,50 m ²
T	Terrace	205,80 m ²

