



“Pristina City Center” is a business center that strives to have not only the most modern architecture, but also dedicated projects with staff and consolidated partners. Our collaborations are an added value in achieving common goals while joining the public and private sector in a single communication network.

 **IN JUST  
FEW MINUTES**

FADIL VOKRRI  
Stadium



GRAND  
Hotel



5 min

5 min



Municipality  
Building of  
Pristina

10 min

7 min



University  
of Pristina

3 min

5 min



BILL CLINTON  
Statue

5 min



KEDS



Cathedral of  
Saint Mother Teresa

# SURFACE ANALYSIS EAST TOWER

# 3

FLOOR 29  
SMALL FLAT

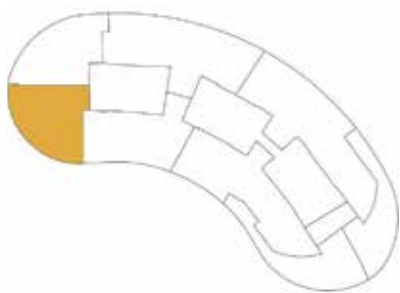

**GROSS SURFACE**  
(selling surface)

**160,70 m<sup>2</sup>**

TOTAL (NET SURFACE)

**131,00 m<sup>2</sup>**

Subdivision of the spaces (net surface)

|      |                |                      |
|------|----------------|----------------------|
| L    | Living         | 44,40 m <sup>2</sup> |
| K    | Kitchen        | 7,30 m <sup>2</sup>  |
| MB   | Master Bedroom | 16,70 m <sup>2</sup> |
| WR   | Wardrobe Room  | 3,80 m <sup>2</sup>  |
| B1   | Bedroom 1      | 21,70 m <sup>2</sup> |
| WC1  | Bathroom 1     | 5,00 m <sup>2</sup>  |
| WC2  | Bathroom 2     | 4,40 m <sup>2</sup>  |
| WC3  | Bathroom 3     | 2,70 m <sup>2</sup>  |
| C/LA | Closet/Laundry | 3,30 m <sup>2</sup>  |
| F    | Foyer          | 6,30 m <sup>2</sup>  |
| H    | Hallway        | 3,40 m <sup>2</sup>  |
| LO   | Loggia         | 12,00 m <sup>2</sup> |

