



“Pristina City Center” is a business center that strives to have not only the most modern architecture, but also dedicated projects with staff and consolidated partners. Our collaborations are an added value in achieving common goals while joining the public and private sector in a single communication network.

 **IN JUST  
FEW MINUTES**

FADIL VOKRRI  
Stadium



GRAND  
Hotel



5 min

5 min



10 min

Municipality  
Building of  
Pristina

7 min



University  
of Pristina

3 min

5 min



BILL CLINTON  
Statue

5 min



KEDS



Cathedral of  
Saint Mother Teresa

# SURFACE ANALYSIS EAST TOWER



FLOOR 29  
PENTHOUSE

# 1

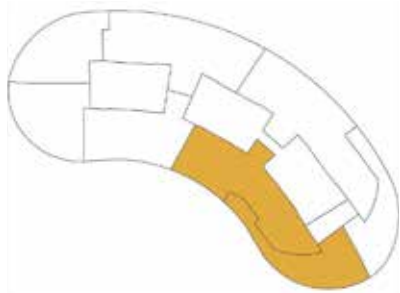

GROSS SURFACE <small>(selling surface)</small>	386,70 m <sup>2</sup>
GROSS SURFACE APT.	223,70 m <sup>2</sup>
GROSS SURFACE TERRACE	163,00 m <sup>2</sup>

TOTAL (NET SURFACE) 335,20 m<sup>2</sup>

Subdivision of the spaces (net surface)

L	Living	79,90 m <sup>2</sup>
K	Kitchen	12,80 m <sup>2</sup>
MB	Master Bedroom	19,50 m <sup>2</sup>
WR1	Wardrobe Room 1	6,00 m <sup>2</sup>
WR2	Wardrobe Room 2	5,70 m <sup>2</sup>
B1	Bedroom 1	14,40 m <sup>2</sup>
B2	Bedroom 2	19,30 m <sup>2</sup>
WC1	Bathroom 1	3,50 m <sup>2</sup>
WC2	Bathroom 2	5,40 m <sup>2</sup>
WC3	Bathroom 3	5,20 m <sup>2</sup>
C	Closet	3,00 m <sup>2</sup>
LA	Laundry	3,00 m <sup>2</sup>
F	Foyer	8,90 m <sup>2</sup>
H	Hallway	10,50 m <sup>2</sup>
T	Terrace	138,10 m <sup>2</sup>

